



Engel Park

£2,350,000

BREATHTAKING SIX BEDROOM DETACHED HOUSE - OVER 4100 SQ FT OF LUXURIOUS LIVING SPACE- LOCATED WITHIN WALKING DISTANCE OF MILL HILL EAST STATION - VIEWINGS HIGHLY ADVISED Cosway Estates are proud to present a beautiful and imposing SIX Bedroom, Six Bathroom Detached family home, set securely behind electric gates, located on the corner of Engel Park and The Ridgway. The property, which has been decorated and modernised to the highest standard, consists of a Two large separate living rooms, dining room, office, utility room, down stairs W/C. The kitchen is beautifully designed by 'Smallbone' and features full Mille appliances. The property also benefits from underfloor heating throughout the ground floor and in the bathrooms, Sonos sound systems installed throughout and CCTV installed both internally and externally. The First Floor consists of a luxurious Master Suite with walk in wardrobe and en suite bathroom, Three further double bedrooms each sporting their own en suite bathroom. Located on the Second Floor are four further bedrooms with two separate shower rooms. The rear of the property consists of a mature and sunny, South-West facing garden with a large sun terrace. Further benefits include Cat 5 wiring throughout, Air-conditioning throughout, Gate entry system from all levels of the house. Sole Agents

Viewing

Please contact our Mill Hill Office on 020 8959 0011 if you wish to arrange a viewing appointment for this property or require further information.



6



6



3



Floor Plan

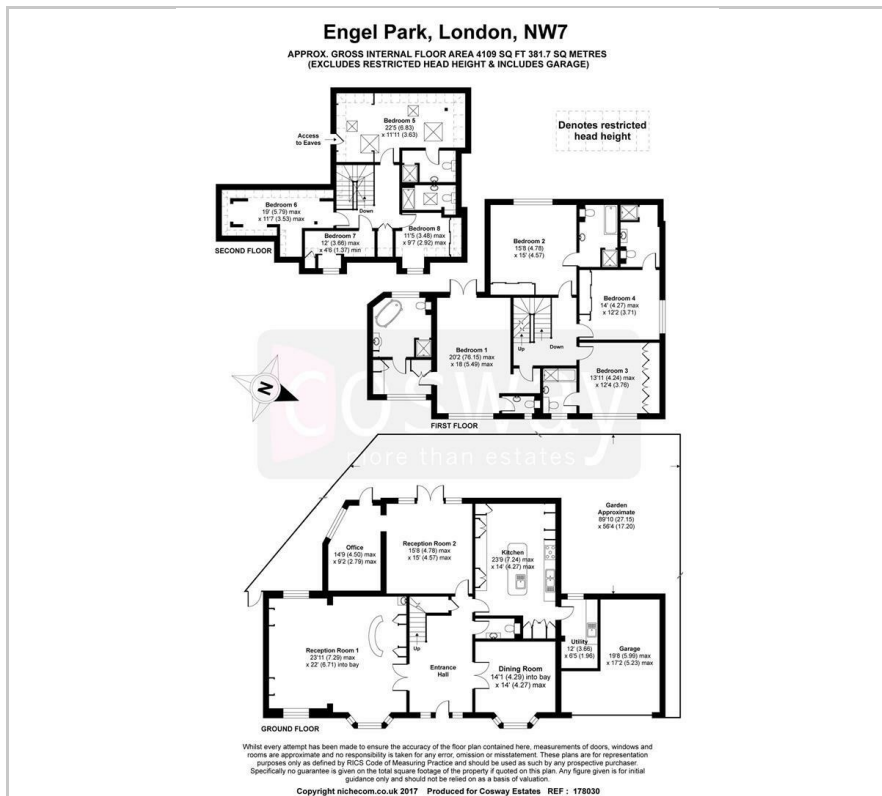

Area Map

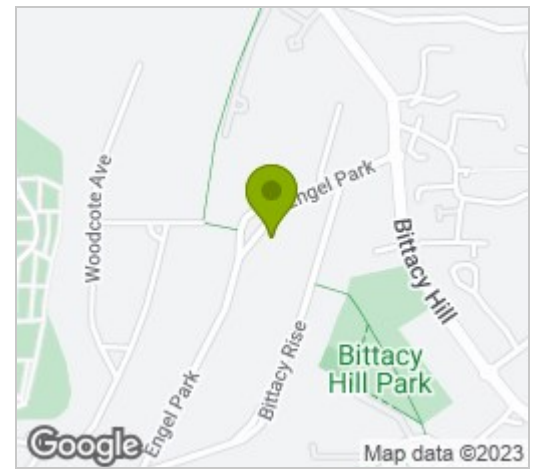

Energy Efficiency Graph



These particulars, whilst believed to be accurate are set out as a general outline only for guidance and do not constitute any part of an offer or contract. Intending purchasers should not rely on them as statements of representation of fact, but must satisfy themselves by inspection or otherwise as to their accuracy. No person in this firm's employment has the authority to make or give any representation or warranty in respect of the property.